

Dimensions in Inches, Tolerances: ±.015 for hole diameters.  
Other tolerances ±.030 unless otherwise noted.

## DC AMMETER SHUNT SERIES 214

### FEATURES

- Measuring range: 600A to 10,000A
- Output range: 50mV and 100mV
- Composed of manganin and either brass (for shunts rated below 10,000A) or copper (for shunts rated 10,000A and higher)
- Constant current distribution to shunt strips
- Terminal blocks are slotted to receive one-quarter (1/4) inch bar per slot
- STD Accuracy ±0.25% (0.1% available upon request.)

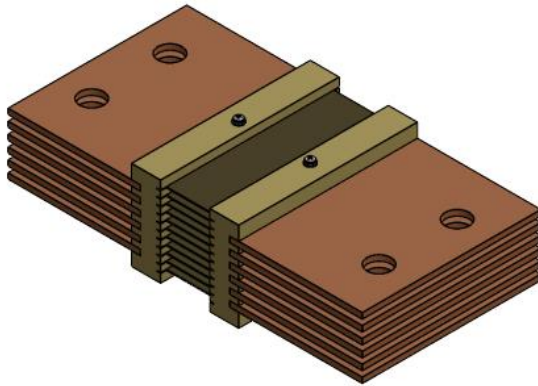

### RECOMMENDATIONS

- Shunts should be mounted on the grounded side of the circuit (or mounted on the grounded side of circuits above 750 volts for panel mounted shunts with insulated bases.)
- Shunts should run for no more than two-thirds (2/3) the rated current under normal conditions as per AIEEE standards.
- The manganin shunt strip must not exceed 145°C, as this will cause permanent change in resistance.
- If longer lead lengths are necessary, the additional IR (millivolt) drop in the leads must be taken into consideration when ordering instruments.
- Shunts may be connected (without error) in parallel to measure heavy currents providing each shunt has a separate pair or millivolt leads connected to the instrument terminals.
- The resistance blades of the shunt should be mounted in a vertical position with the longitudinal axis of the shunt in a horizontal position in order to promote the free convectational flow of air.

### 50 mV

Catalog Number	AMP	A	B	C	D	E	F	G	H	J	K
214-1000-50	1000	9 1/16	3	1 1/2	7 15/32	17/32	1 1/2	3/4	2	2 5/8	51/64
214-1200-50	1200	9 1/16	3	1 1/2	7 15/32	17/32	1 1/2	3/4	2	2 5/8	51/64
214-1500-50	1500	9 1/16	3	2	7 15/32	17/32	1 1/2	3/4	3	2 5/8	51/64
214-2000-50	2000	9 1/16	4	2	7 15/32	17/32	2	1	3	2 5/8	51/64
214-2500-50	2500	15 5/8	4	3	11 55/64	21/32	2	1	3	5 1/2	1 7/8
214-3000-50	3000	15 5/8	4	3	11 55/64	21/32	2	1	4	5 1/2	1 7/8
214-4000-50	4000	15 5/8	5	3	11 55/64	13/16	2	1 1/2	4	5 1/2	1 7/8
214-5000-50	5000	15 5/8	5	4	11 55/64	13/16	2	1 1/2	5	5 1/2	1 7/8
214-6000-50	6000	15 5/8	6	4	12 23/64	13/16	2 3/4	1 5/8	5	5 1/2	1 41/64
214-7500-50	7500	15 5/8	6	4	12 23/64	13/16	2 3/4	1 5/8	6	5 1/2	1 41/64
214-8000-50	8000	15 5/8	6	4	12 23/64	13/16	2 3/4	1 5/8	6	5 1/2	1 41/64
214-10000-50	10000	15 55/64	8	4	12 55/64	1 1/16	3 1/2	2 1/4	6	5 17/32	1 1/2

FOUR INSTRUMENT TERMINALS FURNISHED  
ON SHUNTS ABOVE 3000 AMPS.

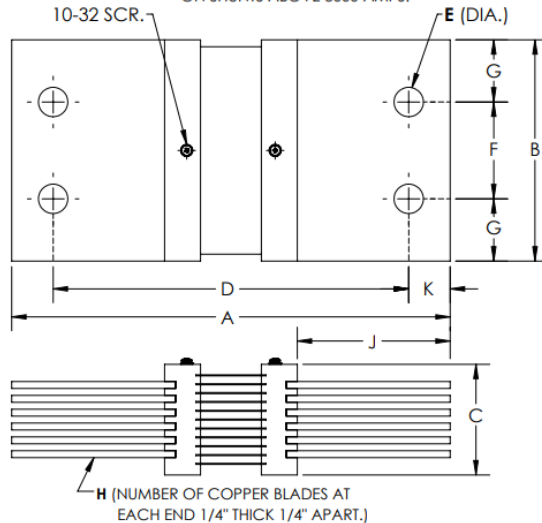

### 100 mV

Catalog Number	AMP	A	B	C	D	E	F	G	H	J	K
214-600-100	600	12	3	1 1/2	10 1/2	17/32	1 1/2	3/4	2	2 5/8	3/4
214-750-100	750	12	3	1 1/2	10 1/2	17/32	1 1/2	3/4	2	2 5/8	3/4
214-800-100	800	12	3	1 1/2	10 1/2	17/32	1 1/2	3/4	2	2 5/8	3/4
214-1000-100	1000	12	3	2	10 1/2	17/32	1 1/2	3/4	3	2 5/8	3/4
214-1200-100	1200	12	4	2	10 1/2	17/32	2	1	3	2 5/8	3/4
214-1500-100	1500	18 1/2	4	3	15	21/32	2	1	3	5 9/32	1 3/4
214-2000-100	2000	18 1/2	4	3	15	21/32	2	1	3	5 9/32	1 3/4
214-2500-100	2500	18 1/2	5	3	15	21/32	2	1 1/2	3	5 9/32	1 3/4
214-3000-100	3000	18 1/2	5	4	15	21/32	2	1 1/2	4	5 9/32	1 3/4
214-4000-100	4000	18 9/16	5	4	15	13/16	2 1/2	1 1/4	4	5 9/32	1 25/32
214-5000-100	5000	18 9/16	5	4	15	13/16	2 1/2	1 1/4	5	5 9/32	1 25/32
214-6000-100	6000	18 9/16	6	4	15 1/2	13/16	3	1 1/2	5	5 9/32	1 17/32

**AAC**

**214 SERIES**

**Rev.  
A**