

Dimensions in Inches, Tolerances: .XX ± .03 .XXX ± .010

**AC CURRENT TRANSDUCER
SERIES 1003AM2
TWO WIRE SELF POWER**

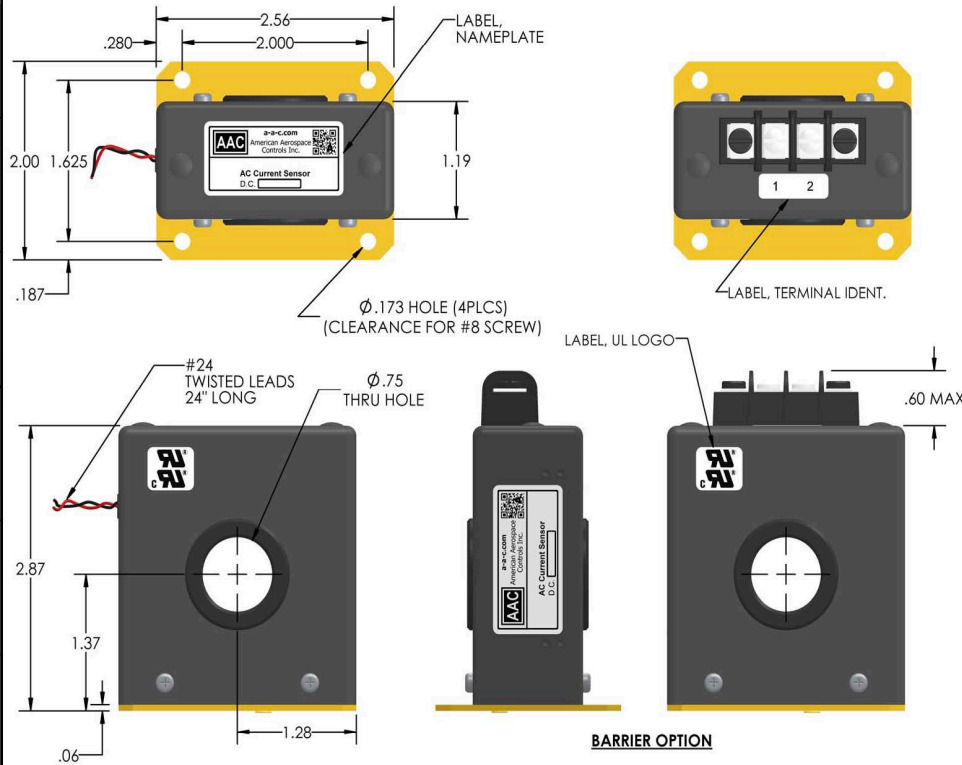

PART NUMBER	CURRENT RANGE	OUTPUT IMPEDANCE
1003AM2-10	0 to 10Aac	7
1003AM2-15	0 to 15Aac	5
1003AM2-20	0 to 20Aac	3.5
1003AM2-25	0 to 25Aac	3.0
1003AM2-30	0 to 30Aac	2.5
1003AM2-50	0 to 50Aac	1.5
1003AM2-75	0 to 75Aac	1.0
1003AM2-100	0 to 100Aac	0.7
1003AM2-125	0 to 125Aac	0.6
1003AM2-150	0 to 150Aac	0.5
1003AM2-200	0 to 200Aac	0.4
1003AM2-250	0 to 250Aac	0.3
1003AM2-300	0 to 300Aac	0.25

INPUT

CURRENT RANGE	See Table (Amps AC RMS)
FREQUENCY	47 to 63Hz
FREQUENCY RANGE	47 to 400Hz
INPUT CONDUCTOR VOLTAGE	750Vac Non Insulated Cable
OVERLOAD	500Aac Continuous

OUTPUT

VOLTAGE SIGNAL	0 to 5Vdc FS (Full Scale)
ACCURACY	± 0.5% FS
RIPPLE	0.2%FS (10mV RMS max)
RESPONSE (10 to 90%)	200 m-sec max.
REPEATABILITY	± 0.2% FS
TEMPERATURE COEFFICIENT	±150 PPM/°C max.
OUTPUT IMPEDANCE	K-Ohms See Table
OUTPUT SIGNAL @ OVERLOAD	10Vdc max.

POWER SUPPLY

SUPPLY VOLTAGE	None, self-power
----------------	------------------

ENVIRONMENTAL AND PHYSICAL CHARACTERISTICS

OPERATING TEMPERATURE RANGE	-55°C to +85°C
STORAGE TEMPERATURE RANGE	-55°C to +85°C
HUMIDITY (Operating)	0% to 95%RH
MOISTURE RESISTANCE	MIL-STD-202 Method 106 (Note 2)
RANDOM VIBRATION (Operating)	MIL-STD-810F TBD
SHOCK	50g 11m-sec half sine pulse
ISOLATION	Input/Output/Case
INSULATION RESISTANCE	100 M-Ohms output to case
HOUSING FINISH	Black Polyester Powder Coat
WEIGHT	8 oz. max.

Note 1 Transducers are average responding calibrated to the RMS Value of the input current



ORDERING INFORMATION

1003AM2	-	10	-	B
SERIES		CURRENT RANGE		TERMINATION
				Blank: Fly Leads B: Barrier

TERMINAL IDENTIFICATION

1-RED: VOLTAGE SIGNAL (+)
2-BLACK: VOLTAGE SIGNAL (RTN)

Fly Leads: 24AWG PVC Insulated Leads 24" long
Barrier: Molded terminal block with 6-32 terminal screws 3/8 in. center to center spacing.
Accepts wire sizes up to 14 AWG & wire lugs up to 9/32 in. wide.

AAC	Drawing Number 1003AM2	Rev. H
------------	---	-------------------------