

Dimensions in Inches, Tolerances: .XX ± .03 .XXX ± .010

**AC RMS CURRENT TRANSDUCER
SERIES S461
REMOVABLE YOKE TYPE**

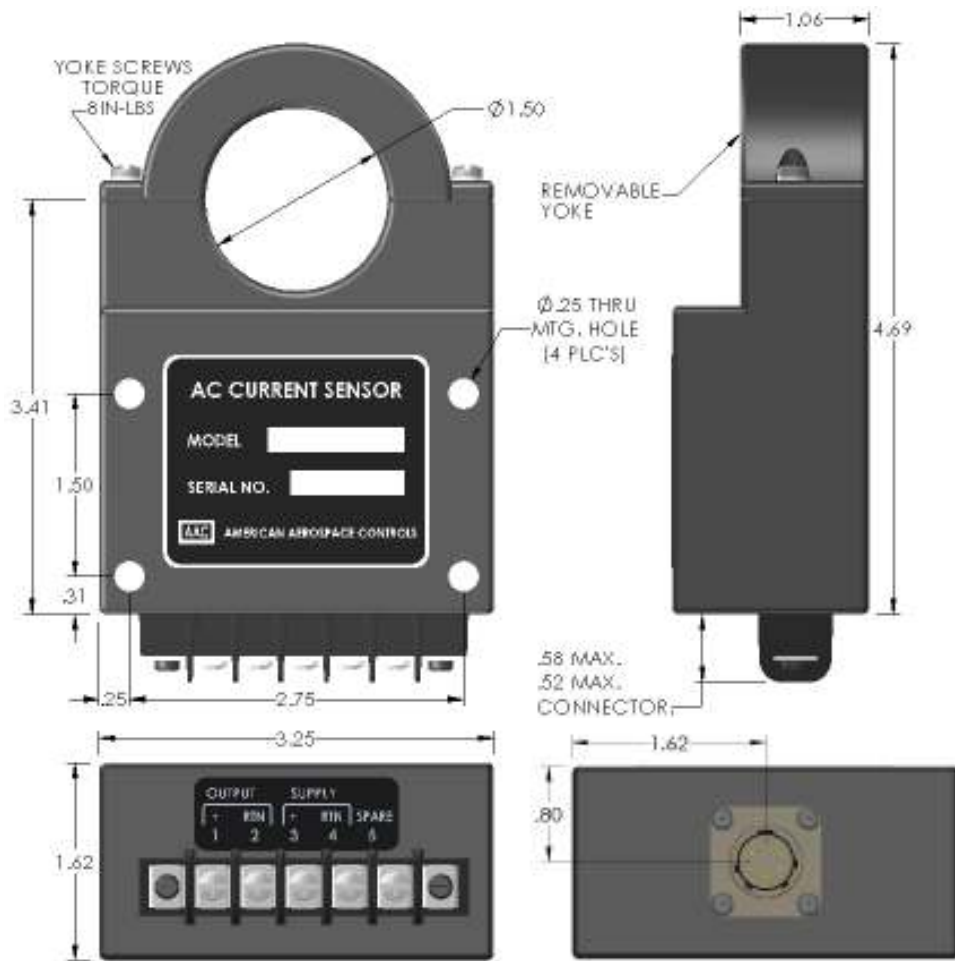

BARRIER STANDARD:

MOLDED TERMINAL BLOCK WITH 6-32 TERMINAL SCREWS, .325 IN. CENTER TO CENTER SPACING. ACCEPTS WIRE SIZES UP TO 16 AWG AND WIRE LUGS TO .250 IN. WIDE.

CONNECTOR OPTION

ADD -C AFTER PART NUMBER; CONNECTOR P/N PT02E-10-6P-023. MATING CONNECTOR PT06A-10-6S-023 OR EQUIV.

TERMINAL IDENTIFICATION

BARRIER	CONNECTOR
1	A
2	B
3	C
4	D
5	E
NA	F

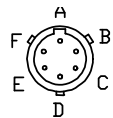

_CONNECTOR

PART NUMBER	INPUT CURRENT	PART NUMBER	INPUT CURRENT
S461-100	0 TO 100	S461-1000	0 TO 1000
S461-150	0 TO 150	S461-1500	0 TO 1500
S461-250	0 TO 250	S461-2000	0 TO 2000
S461-500	0 TO 500	S461-2500	0 TO 2500
S461-750	0 TO 750	S461-3000	0 TO 3000

INPUT

RANGE See Table (DC or AC Peak)
 FREQUENCY DC to 480Hz
 CREST FACTORS Up to 5
 OVERLOAD 2X range continuously, 10X for 10 sec.
 ISOLATION 1KV RMS 60Hz/1min. Non-Insulated cable, 5KV RMS with Insulated cable.

OUTPUT

VOLTAGE SIGNAL 0 to 5Vdc (Full Scale)
 ACCURACY ±1% FS (±50mV)
 RESPONSE (0 to 90%) 100 m-sec
 RIPPLE 25mV RMS @ 60Hz
 LOAD 2K Ohms min.
 TEMPERATURE COEFFICIENT ± .04% FS/°C max.
 OUTPUT IMPEDANCE 10 Ohms max.
 OUTPUT PROTECTION Short circuit continuously

POWER SUPPLY

SUPPLY VOLTAGE +11 to 32Vdc
 CURRENT DRAIN 20mA max.
 OVER VOLTAGE PROTECTION ±35Vdc without damage
 REVERSE POLARITY PROTECTION 10µA max current drain without damage.

ENVIRONMENTAL AND PHYSICAL CHARACTERISTICS

OPERATING TEMPERATURE RANGE -40°C to +85°C
 STORAGE TEMPERATURE RANGE -55°C to +85°C
 DIELECTRIC STRENGTH 350V RMS (all terminals to case)
 INSULATION RESISTANCE 100M-Ohms (all terminals to case)
 ALTITUDE (OPERATING) Sea level to 60,000 ft.
 VIBRATION (OPERATING) 0.06 in. D.A., 10 to 55 Hz (Method 201 of MIL-STD-202)
 SHOCK (OPERATING) 50g, 11 m-sec half sine pulse Method 213, Condition A of MIL-STD-202.
 MOISTURE RESISTANCE MIL-STD-810 method 507.1 Proc. 1
 OPERATING HUMIDITY 0% to 95% RH
 ATTITUDE Unit will perform as specified when mounted in any position.
 CASE MATERIA (Molded Plastic) UL flammability rating 94V-0
 WEIGHT 12 oz. max.

AAC	Drawing Number 700-S461-1001	Rev. C
------------	---	-------------------