

**DC CURRENT LEVEL DETECTOR
PART NUMBER S754-1**

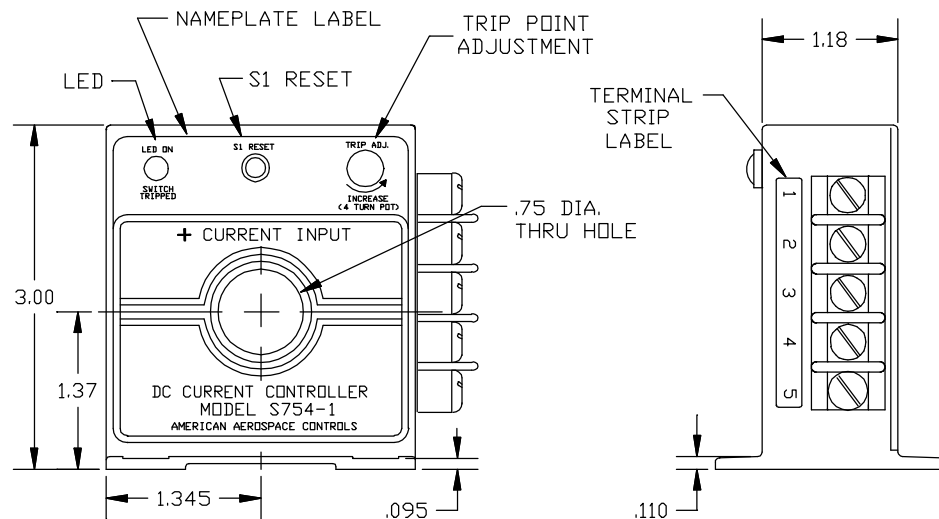
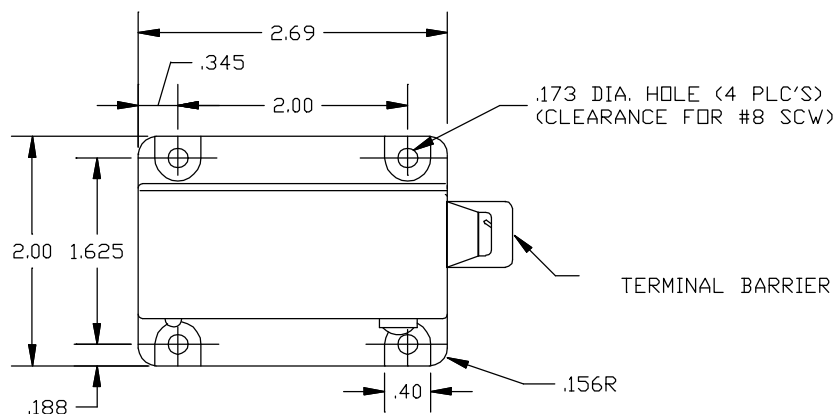

INPUT

RANGE 0 to +20Adc (Continuous)

TRIP POINT SETTING

SET POINT 625mAdc
 TRIP POINT REPEATABILITY 5%
 TRIP POINT RESPONSE TIME 100 m-sec.
 ADJUSTMENT RANGE * Field Adjustable From 500mAdc to 1Adc

RESET POINT SETTING

RESET Manual by depressing reset switch (S1)

OUTPUT RELAY (Solid State)

RELAY CONTACT (SPST) Contacts Open at and above trip point
 CONTACT RESISTANCE On 1.5 Ohms Max, Off 100M Ohms Min.
 DIELECTRIC STRENGTH 2.5KV RMS 60Hz
 CURRENT RATING 600mAdc max.
 OPEN CIRCUIT VOLTAGE 55Vdc Max.
 INDICATOR LED on at & above trip point

POWER SUPPLY

SUPPLY VOLTAGE +25 to 45Vdc
 CURRENT DRAIN 40mA max.
 TRANSIENT PROTECTION ±60V Peak (30sec.); ±100V Peak (2m sec.)

ENVIRONMENTAL AND PHYSICAL CHARACTERISTICS

OPERATING TEMPERATURE -40°C to +85°C
 STORAGE TEMPERATURE -45°C to +85°C
 OPERATING HUMIDITY 0 to 95% Relative Humidity
 INSULATION RESISTANCE 500 M-ohms @ 500Vdc
 DIELECTRIC STRENGTH 2.5Kv RMS 60Hz
 PRIMARY CONDUCTOR VOLTAGE 1000Vdc max.
 CASE Moulded Plastic (GE Lexan) Meets UL Flammability Rating 94 V-0
 WEIGHT 12 oz. max.

* FACTORY SET AT 750mA

NOTE:

- MOLDED TERMINAL BLOCK WITH 8-32 TERMINAL SCREWS, 7/16 IN. CENTER TO CENTER SPACING. ACCEPTS WIRE SIZES TO 12 AWG. TORQUE 9 IN-LB MAX.
- RECOMMENDED MOUNTING HARDWARE #8 SCREW, #8 SPLIT LOCKWASHER AND #8 FLAT WASHER. TORQUE MAXIMUM 18 IN-LB.

TERMINAL IDENTIFICATION

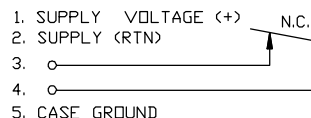

AAC	Drawing Number 700-S754	Rev. C
------------	------------------------------------	-------------------