

Dimensions in Inches, Tolerances: .XX ± .03 .XXX ± .010

**BIDIRECTIONAL CURRENT TRANSDUCER
SERIES 947**

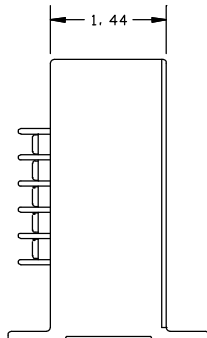
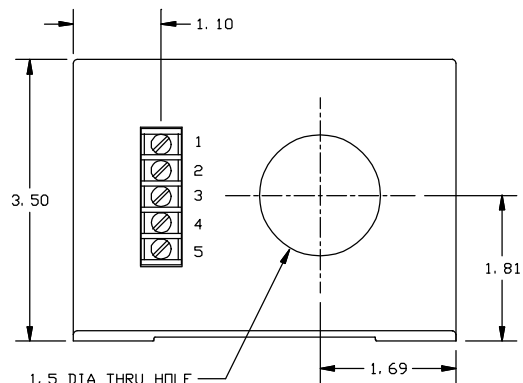
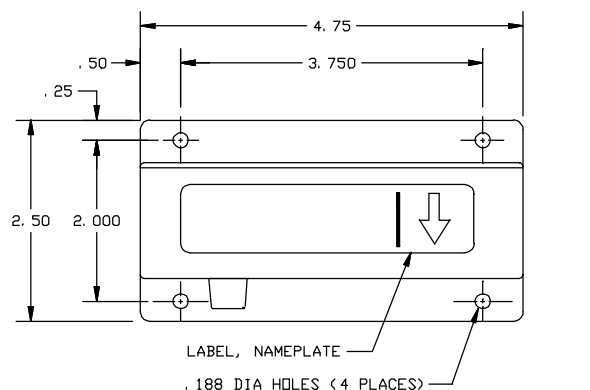

PART NO.	INPUT CURRENT	TEMPERATURE COEFFICIENT
947-100	0 to ±100	.02%
947-200	0 to ±200	.01%
947-300	0 to ±300	.01%
947-400	0 to ±400	.01%
947-500	0 to ±500	.01%
947-600	0 to ±600	.01%

INPUT

RANGE Amps. DC or AC peak. See Table
 CURRENT OVERLOAD ±5000 amps. DC continuous
 FREQUENCY DC to 100KHz

OUTPUT

VOLTAGE SIGNAL 0 to ±5Vdc FS (Full Scale)
 ACCURACY ± 0.5% FS
 LINEARITY ±0.1% FS
 DI DT CAPABILITY 50A per u-sec
 DELAY TIME 1 u-sec
 OUTPUT IMPEDANCE 100 Ohms max.
 TEMPERATURE COEFFICIENT % FS per °C. See Table

POWER SUPPLY

SUPPLY VOLTAGE ±15Vdc ±1Vdc
 CURRENT DRAIN 150mA max.
 REVERSE POLARITY PROTECTION 10µA max. current drain without damage

ENVIRONMENTAL AND PHYSICAL CHARACTERISTICS

OPERATING TEMPERATURE - 20° C to 70°C
 STORAGE TEMPERATURE - 45°C to 85°C
 OPERATING HUMIDITY 0% to 95% RH
 INSULATION RESISTANCE 100 M-Ohms min.
 ATTITUDE Unit will perform as specified when mounted in any position.
 SHOCK Operating: 50g, 11 m-sec half sine pulse Method 213 Condition A of MIL-STD-202
 WEIGHT 1.5 lbs. max.

TERMINALS:

6-32 SCREWS, .325" CENTER TO CENTER SPACING, ACCEPTS WIRE SIZES UP TO 14 AWG. AND WIRE LUGS UP TO .26" WIDE.

TERMINAL IDENTIFICATION

1. SUPPLY VOLTAGE (+)
2. SUPPLY VOLTAGE (-)
3. SUPPLY (RTN)
4. OUTPUT (RTN)
5. OUTPUT SIGNAL (±)

AAC	Drawing Number 700-947	Rev. C
------------	----------------------------------	------------------