

Dimensions in Inches, Tolerances: .XX ± .03 .XXX ± .010

**A.C. CURRENT SENSOR  
SERIES 1006**

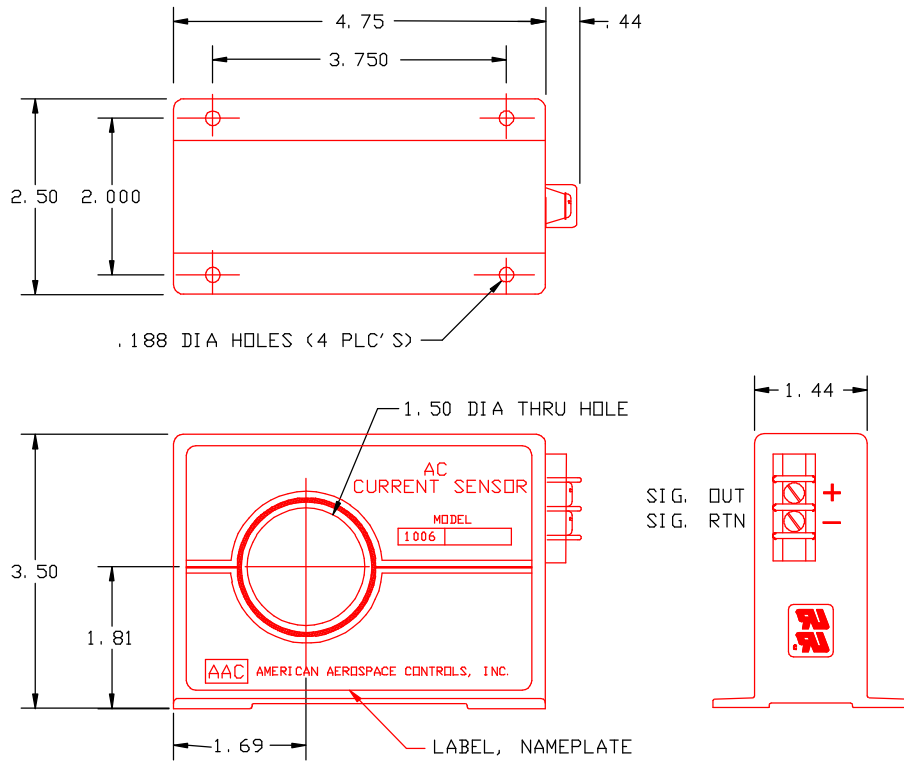

OUTPUT			OUTPUT		
MODEL NO.	INPUT CURRENT	IMPEDANCE	MODEL NO.	INPUT CURRENT	IMPEDANCE
1006-5	0 TO 5	9	1006-200	0 TO 200	.22
1006-10	0 TO 10	4.5	1006-250	0 TO 250	.18
1006-20	0 TO 20	2.2	1006-300	0 TO 300	.22
1006-25	0 TO 25	1.7	1006-350	0 TO 350	.2
1006-30	0 TO 30	1.55	1006-400	0 TO 400	.17
1006-35	0 TO 35	1.4	1006-500	0 TO 500	.13
1006-50	0 TO 50	.88	1006-600	0 TO 600	.11
1006-75	0 TO 75	.61	1006-800	0 TO 800	.12
1006-100	0 TO 100	.45	1006-1000	0 TO 1000	.10
1006-150	0 TO 150	.30			

**INPUT**  
 RANGE ..... Aac See Table  
 FREQUENCY ..... 50 & 60Hz  
 OVERLOAD CONTINUOUS ..... 500Aac or two X FS which ever is greater

**OUTPUT**  
 VOLTAGE SIGNAL ..... 0 to 5Vdc FS (Full Scale) \*  
 ACCURACY ..... ± 0.5% FS  
 RIPPLE (RMS) ..... 10mV RMS typical  
 RESPONSE (10 to 90%) ..... 130m-sec typical  
 IMPEDANCE ..... K Ohms max. See Table  
 TEMPERATURE COEFFICIENT ..... ±0.02% FS/°C max.  
 REPEATABILITY ..... ±0.1% FS  
 VOLTAGE SIGNAL @ OVERLOAD ..... 10Vdc max.  
 VOLTAGE SIGNAL LINEAR TO ..... 6Vdc (120% FS)

**POWER SUPPLY (PS)**  
 SUPPLY VOLTAGE ..... None, Self Excited

**ENVIRONMENTAL AND PHYSICAL CHARACTERISTICS**  
 OPERATING TEMPERATURE RANGE ..... -20° to +70°C  
 STORAGE TEMPERATURE RANGE ..... -55° to +85°C  
 ISOLATION ..... Input/Output/Case  
 CONDUCTOR CABLE VOLTAGE ..... 1.5KV max. (5KV with Insul. Cable)  
 CASE ..... Molded Plastic Meets UL Flammability Rating 94V- 0  
 WEIGHT ..... 1.2 lbs. max.



**TERMINALS:**

5-40 SCREWS, 3/8" CENTER TO CENTER SPACING, ACCEPTS WIRE SIZES UP TO 14 AWG AND WIRE LUGS UP TO 9/32" WIDE.

<b>AAC</b>	<b>Drawing Number 700-1006</b>	<b>Rev. J</b>
------------	------------------------------------	-------------------